

WBM Sample Solution

System Modeling
Fall 2016

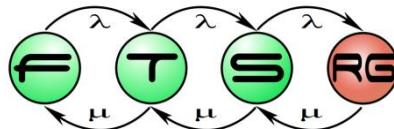

Example (Online bookstore)

- Virtual business item: user session in the system
- Resources: web server, application server, database server, conforming to the three-layer architecture.
- Subprocesses: individual use cases.
- Tasks: elementary activities that together implement the use case.

Customer Behaviour Modeling 1.

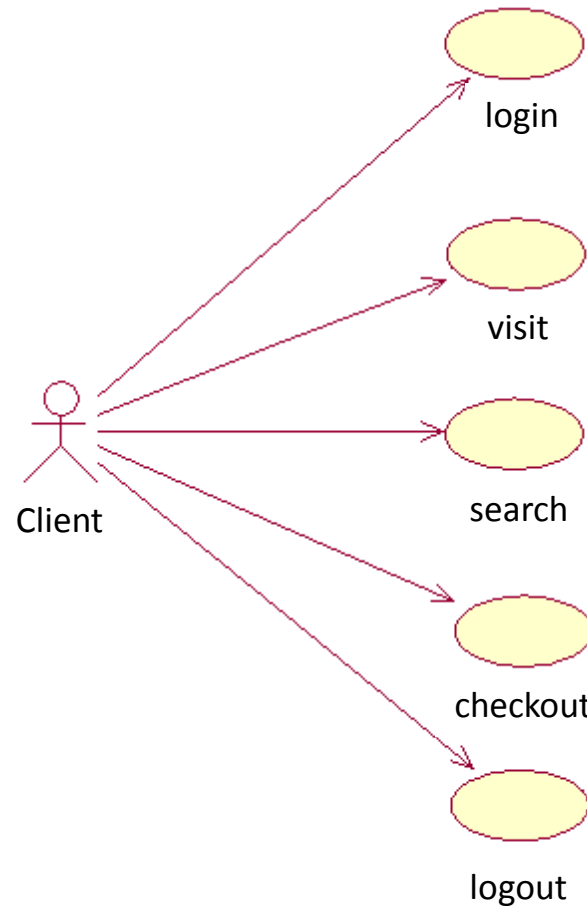

Not a
mandatory
part of the
assignment

Customer Behaviour Modeling(CBMS) 2.

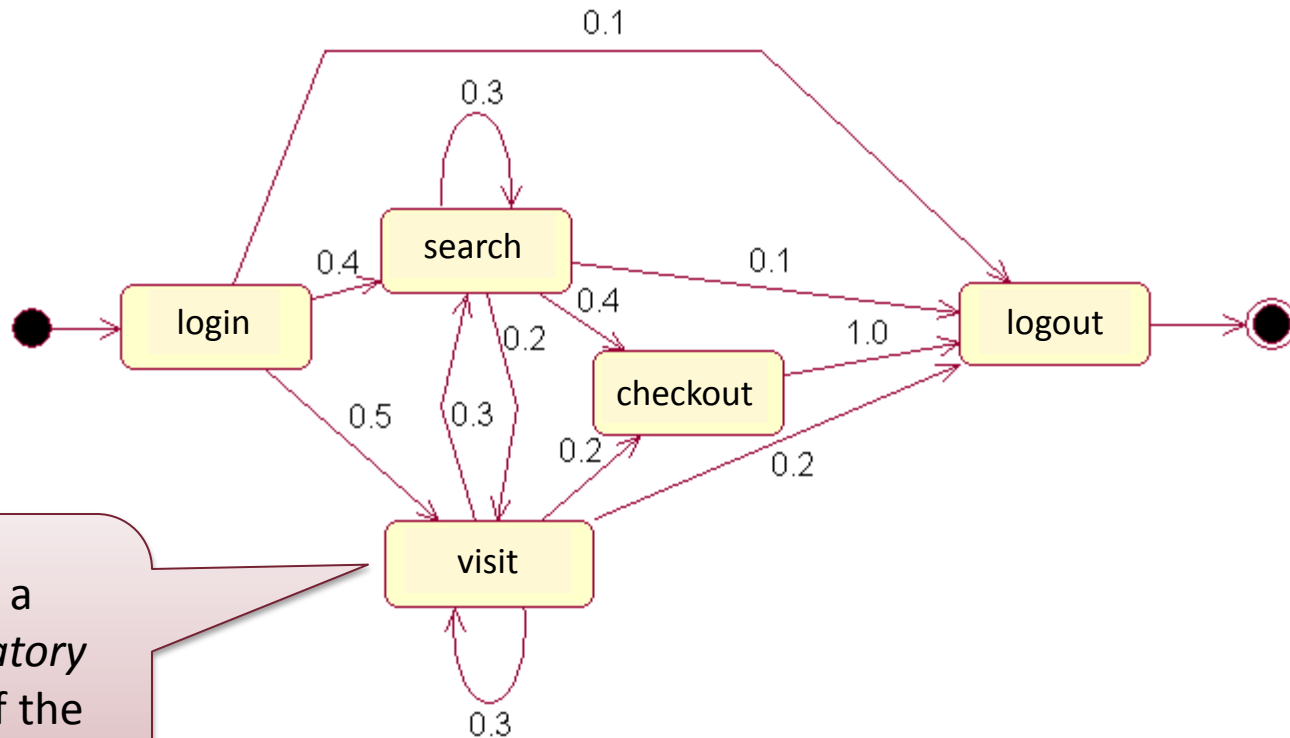

Not a
mandatory
part of the
assignment

Login subprocess

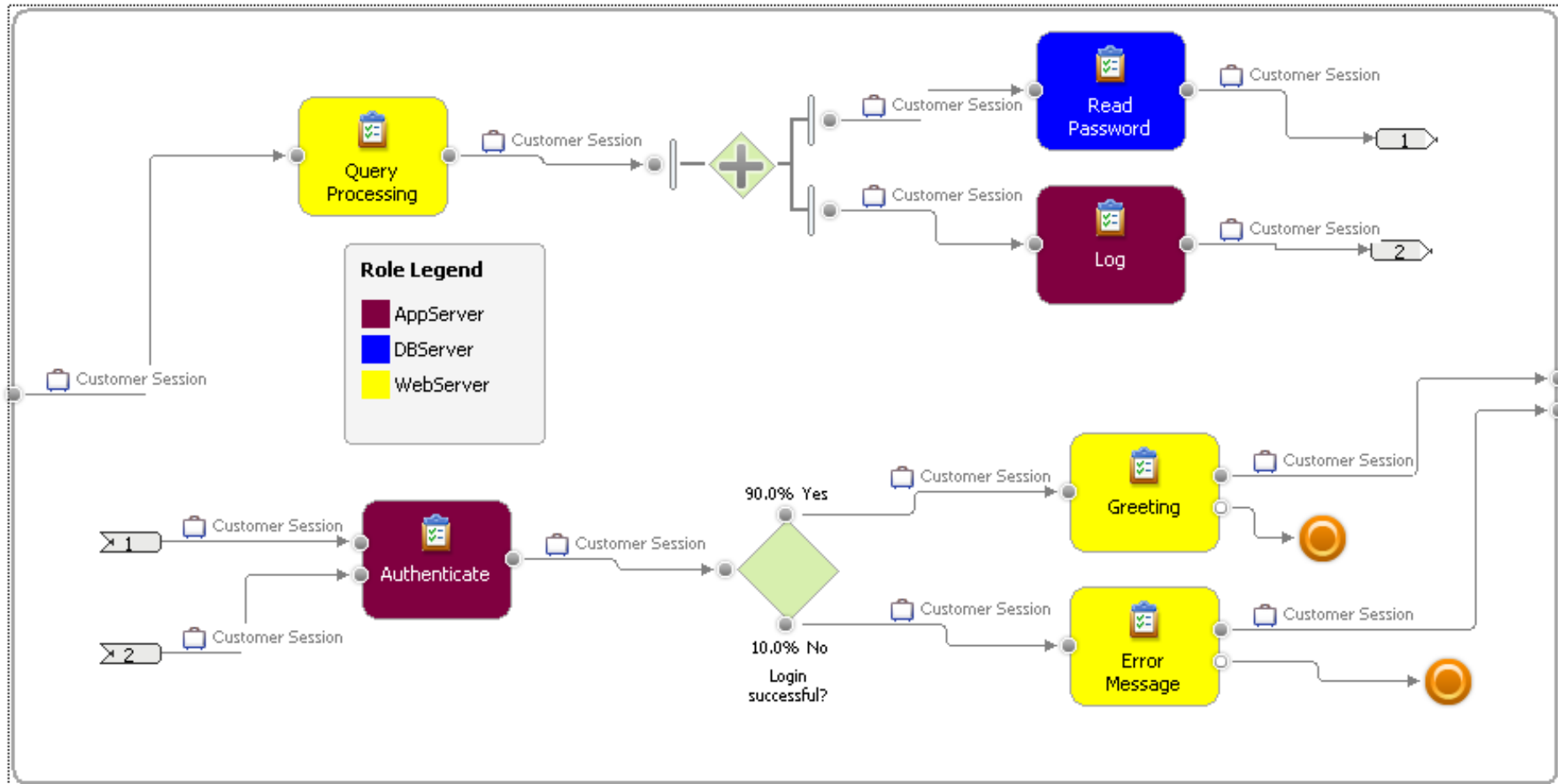

Logout subprocess

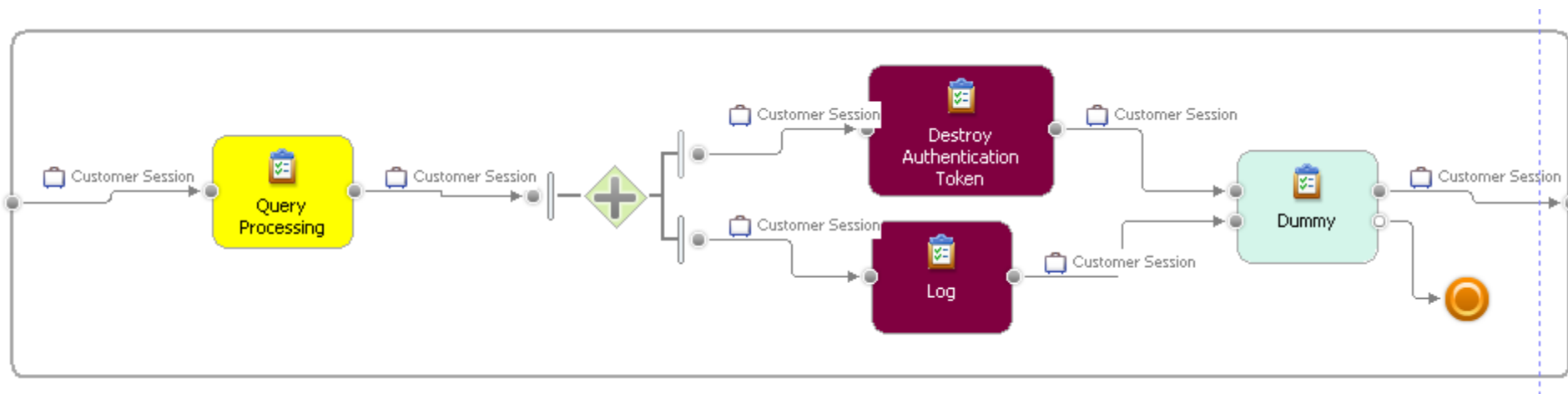

Visit the page of a book

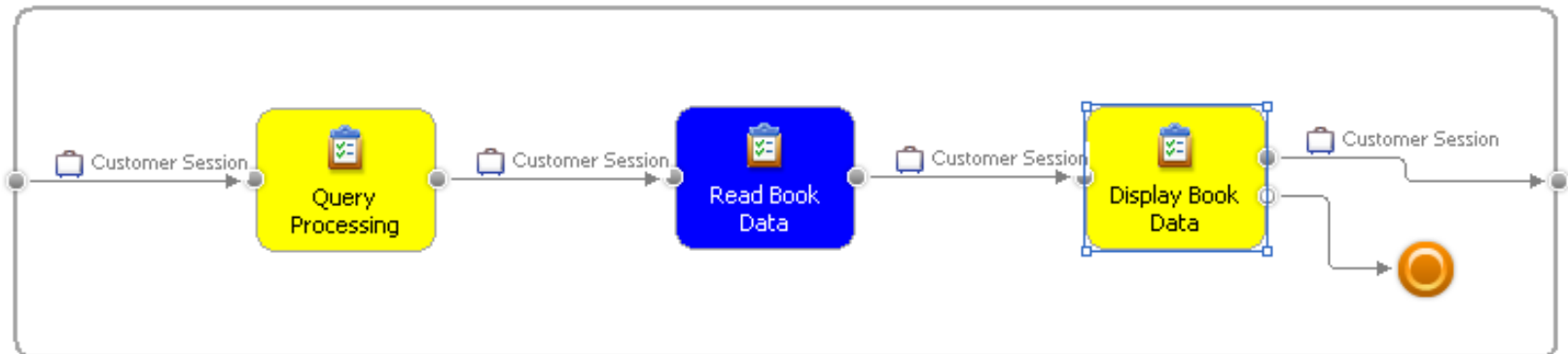

Search

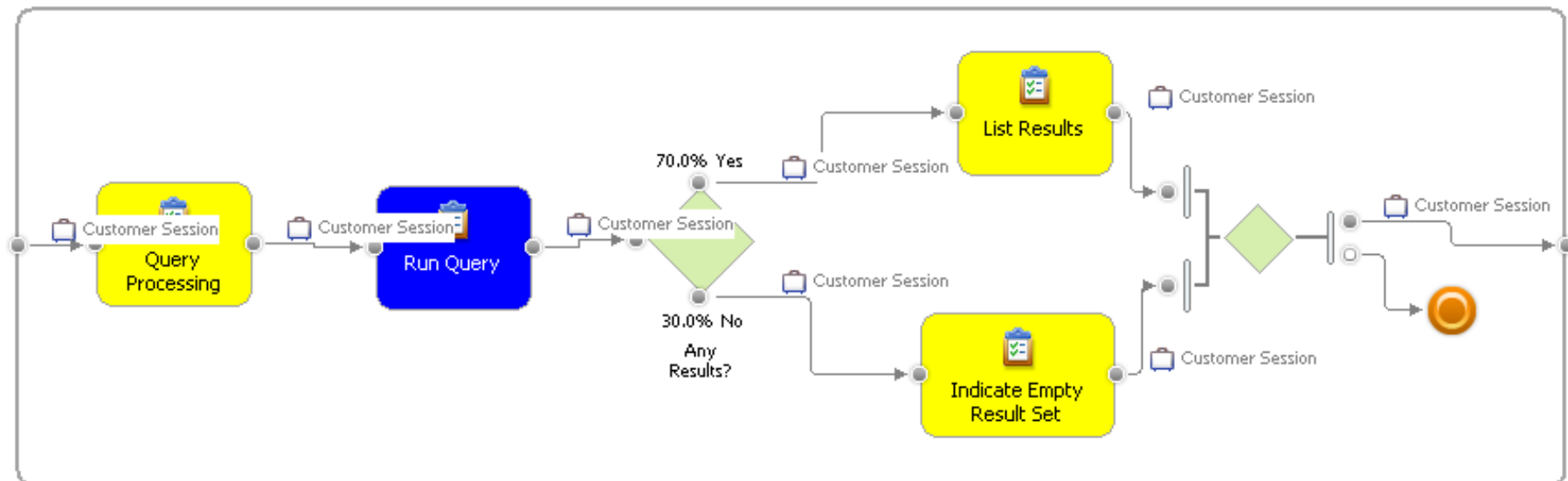

Checkout

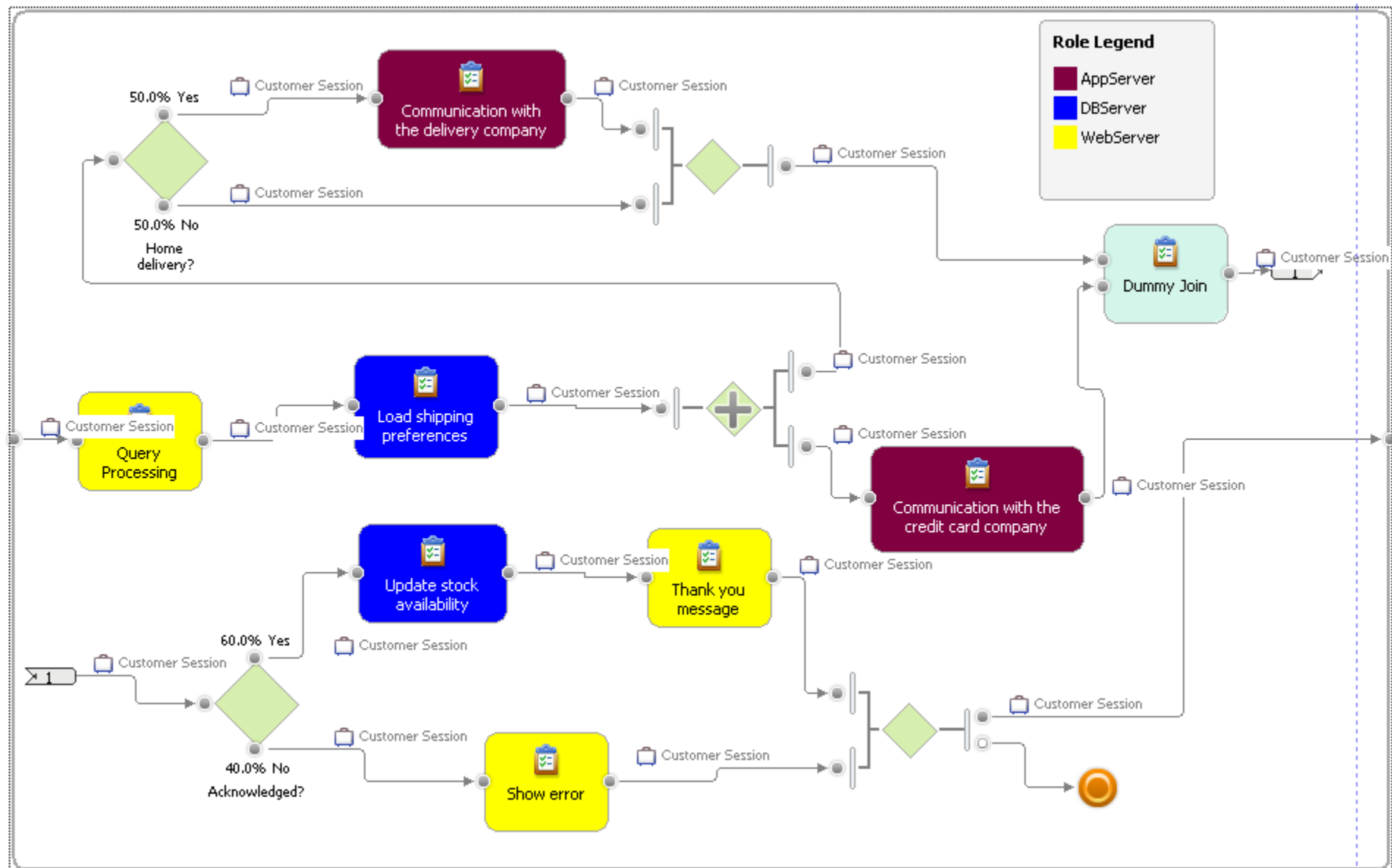

DEMO

WBM V7.0 and sample solution